

DRM PACK

Standard Features

- Top and bottom tape heads
(Adjustable for 2" & 3" tape using the same tape head)
- Extension in/out-feed roller tables
- Adjustable table work height
- Locking roller caster wheels
- Dual mast with top squeezers
- All-metal drive wheel

Specifications

- Dual 1/4HP motors / Powered "side" drive belts
- 30 cartons per minute sealing speed

Power requirement: 110VAC / 60Hz

Max. Load: 80lbs

Carton size

Length: 6.00" to ∞

Width: 4.25" to 19.75"

Height: 4.25" to 19.75"

* 1-year parts warranty *



1/4HP Dual Industrial Motors

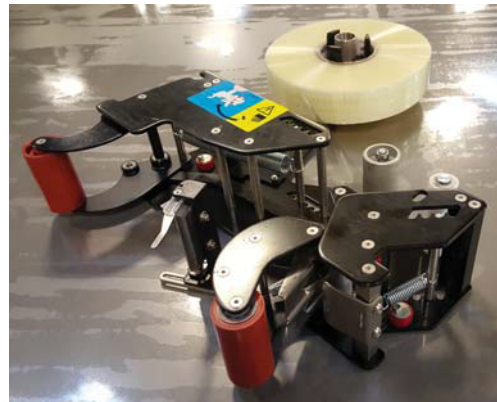
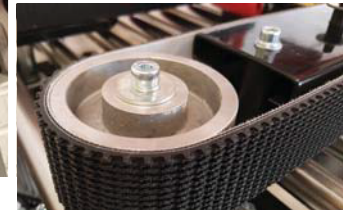

Tape Head Assembly



Control Panel

Dimensions

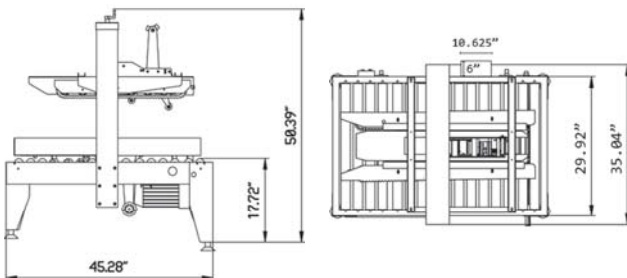

DRM PACK

Stretch Packaging Systems

Production Facilities N. America

D.R.M. Associates LLC

21 Yale Street

Bristol, CT 06010

USA Sales & Marketing

www.drmpack.com

We invite you to go online at www.drmpack.com

860-836-7509

D.R.M. Associates LLC

ASK
ABOUT
A DEMO